

Rocky Mountain Psychological Association Newsletter Spring 2010

Program Chair's Message

Diane Martichuski
University of Colorado

The 80th Annual RMPA Convention should be a great conference! We have about 285 submissions for papers, posters, symposia, and workshops this year, and all of the Rocky Mountain states (Nevada, Utah, Colorado, Wyoming, Montana, Idaho, Arizona, and New Mexico) are represented, as well as Georgia, Arkansas, Indiana, Virginia, Pennsylvania, Nebraska, Washington, Vermont, Oklahoma, Kansas, Florida, California, and North Carolina. This is also the sixth year for the Portenier/Wertheimer Teaching Pre-conference, which will be held starting at noon on Thursday, April 15. In addition to the teaching sessions, which students are welcome to attend, we also have set up special sessions just for students during the teaching pre-conference on Thursday afternoon. We will have the general Conference Kickoff Speaker (Jacquelynne Eccles) at 5 pm on Thursday the 15th and the teaching posters and reception following Eccles' talk from 6 to 7:30 pm. At that time, you can find a group to go to dinner with, if you are interested in meeting new people. Friday and Saturday (April 16 and 17) will have full schedules, like last year. We have many social events planned for this conference, and there are great restaurants around, so please plan on staying in Denver for the entire convention, which will conclude with our President's Reception on Saturday night.



For those who are new to RMPA, please remember that even though you have submitted a proposal, *it is still necessary to register for the convention and reserve rooms at the Sheraton Denver Tech Center.*

Remember, you will not be mailed a convention program. Convention-goers will receive a program when they either pick up their badge (pre-registered people) or when they register on-site at the conference in a few weeks. We otherwise have a brief schedule of the conference as well as a complete copy of the program on the website at <http://www.rockymountainpsych.org>. Click on "2010 Convention Program Information." On that same conference webpage, you can find a "General Guidelines" link for newcomers to the conference, as well as moderator information, and presenter information. If you have any questions or problems with a submission or want to help out more, please contact me at

Diane.Martichuski@colorado.edu.

Recently, we switched to using LCD projectors in all presentation rooms. They were a big success! We are going to continue to have LCD projectors, so bring a memory stick/thumb drive/flash drive/CD with your presentation on it. Many thanks to Metro State College for helping us with this equipment. You no longer need to bring your computer or LCD projector (but still need a memory stick).

Thanks again for all of the great looking proposals! We welcome newcomers and look forward to seeing our "regulars" each year! The executive committee and I are all very excited about this conference!

RMPA 2010 CONVENTION INFORMATION

APRIL 15-17, 2010

Sheraton Denver Tech Center Hotel
7007 South Clinton Street
Greenwood Village, CO 80112
303-799-6200

Convention Manager

Aaron Richmond
 Department of Psychology
 Metropolitan State College of Denver
 Campus Box 54
 PO Box 173362
 Denver, CO 80217-3362
arichmo3@mscd.edu
 303-556-3085



Lodging

Sheraton Denver Tech Center Hotel. Reservations should be made by calling the Sheraton Hotels reservation number at 1-800-325-3535 by March 14, 2010. Please specify that you are attending the RMPA annual meeting in order to get the special rate. Single/double rooms are \$99 (king or two double beds).



Transportation

There is no hotel shuttle from Denver International Airport to the Sheraton Denver Tech. Super Shuttle (currently \$19 one way; \$38 round trip) is recommended; there is a desk at DIA. Telephone 303-370-1300.

Driving Directions

From Denver International Airport (DIA)

If you are driving from DIA, take Pena Blvd to E-470 toll-way South (exit 6-A). Take E-470S until it merges with I-25N (exit 1-A) and head north towards Denver on I-25. Take I-25 North and exit onto Arapahoe Road (Exit 197). Turn right onto Arapahoe Road. Travel approximately 100 feet and turn right on South Clinton Street. The Hotel is about a block down on the left.

From North of Denver (via I-25)

Take I-25 South and exit onto Arapahoe Road (Exit 197). Turn left onto Arapahoe Road and continue past 2 lights. Turn

right onto South Clinton Street. The Hotel is about a block down on the left.

From South of Denver (via I-25)

Take I-25 North and exit onto Arapahoe Road (Exit 197). Turn right onto Arapahoe Road. Travel approximately 100 feet and turn right on South Clinton Street. The Hotel is about a block down on the left.

From the West of Denver (via I-70)

Take I-70 East to US-6E at (exit 261). Travel east for about 8.7 miles and merge onto I-25 South. Exit onto Arapahoe Road (Exit 197) and turn left onto Arapahoe Road. Continue past 2 lights and turn right onto South Clinton Street.

From East of Denver (via I-70)

Traveling west on I-70 exit at E-470S toll-way (exit 289). Take E-470S until it merges with I-25N (exit 1-A) and head north towards Denver on I-25. Take I-25 North and exit onto Arapahoe Road (Exit 197). Turn right onto Arapahoe Road. Travel approximately 100 feet and turn right on South Clinton Street. The Hotel is about a block down on the left.

D
E
N
V
E
R

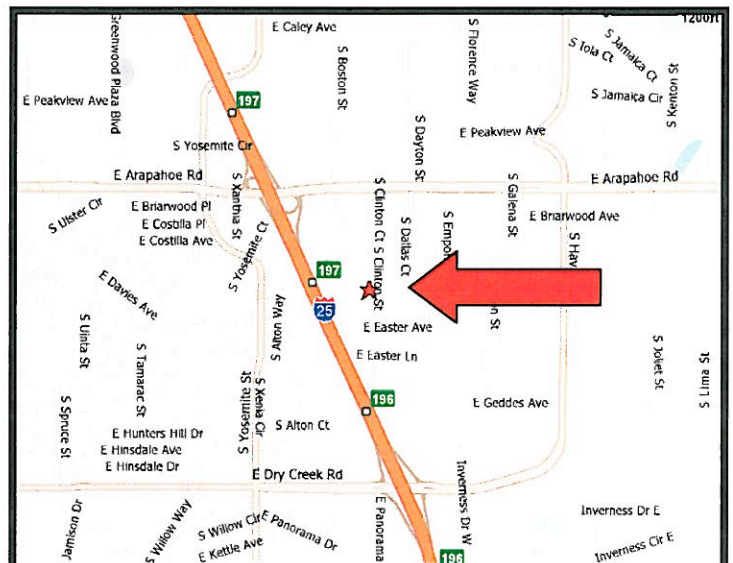
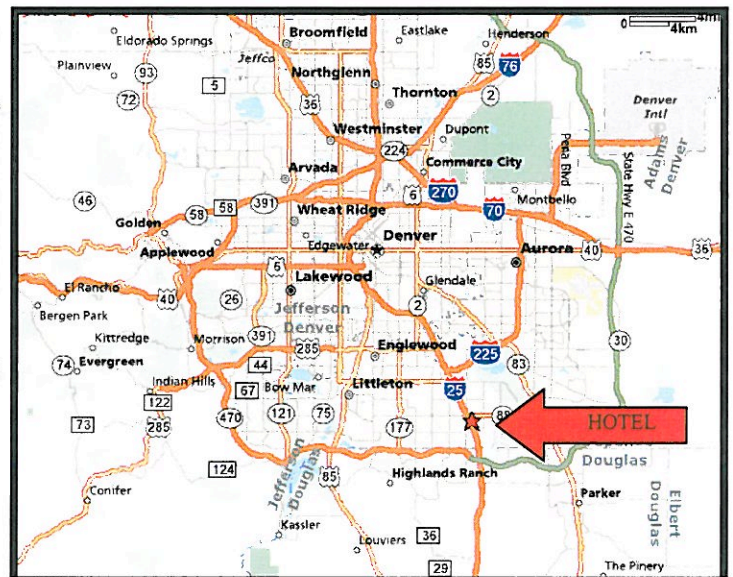



DENVER at a glance:

The Sheraton Denver Tech Center, site of the 2010 RMPA annual meeting, is located just off I-25 south of downtown, the professional sports stadiums and the Pepsi Center. The recently renovated hotel has 263 guest rooms that feature great views of downtown, Pikes Peak, and the Rocky Mountains. In-room amenities include high speed internet connection, a work desk, ironing boards and irons, and complementary coffee and coffee maker. If you choose to upgrade to the Club Level, you will be on the top floor and receive a full breakfast and evening hors d'oeuvres with complementary drinks. Other hotel features include a fitness center with Jacuzzi and outdoor heated pool. Browsers Restaurant (full service), Browsers Library, and Browsers Martini Lounge offer food, drink, and a place to relax.

The Sheraton offers complimentary van service within a 5-mile radius, providing numerous entertainment, shopping, and dining venues from which to choose. These would include the Country Dinner Playhouse (walking distance) and Park Meadows Mall, with Nordstroms, Dillards, Foleys, Lord & Taylor, and several restaurants and specialty shops. Close by are golf courses, bowling lanes, and movie theaters. Restaurant options vary from Applebee's and Bennigan's to Cheesecake Factory, India's Clay Oven, Landry's Seafood House, Macaroni Grill, Maggiano's Little Italy, Morton's of Chicago, Outback, P.F. Chang's, Sahara (Moroccan & Lebanese), and the Trail Dust Steakhouse (also walking distance).

Denver itself is loaded with attractions. For a comprehensive, up-to-the-minute website with information about major current events and destinations in the region, visit one or more of the following:

- www.denver.com/
- www.denver.citysearch.com/
- www.denver.org/

The Denver Museum of Nature & Science (www.dmns.org), Denver Art Museum (www.denverartmuseum.org), Denver Zoo (www.denverzoo.org), Denver Botanic Gardens (www.botanicgardens.org), and the Molly Brown House (www.mollybrown.org) are all outstanding. Check the Denver Museum of Nature and Science's website closer to the convention date for IMAX Theater shows. The Denver Center Theatre Company (www.denvercenter.org) will be showing three plays in repertory during April, 2010: *Othello*, *Mama Hated Diesels*, and *Mariela in the Desert*.

Denver has much more to offer in addition to museums and cultural events. There are numerous beautiful city parks, including Red Rocks Park, Confluence Park at the confluence of the Platte River and Cherry Creek, City Park right next to

the zoo, and Dinosaur Ridge (with dinosaur tracks visible from the road). The more ambitious among us might want to take a look at www.trails.com, where you can find lists of such things as the best hiking in Colorado, the best fly-fishing, and the best scenic drives. Bergen Peak is a beautiful hike, and will take you up to 9708 feet. For the more sedate, the Brown Palace Hotel in downtown Denver has been open continuously since 1892; the eight-story atrium lobby is magnificent and tours and wonderful dining are available. The 16th Street Mall and Larimer Square are close by as well. Denver's ethnic neighborhoods have some great restaurants, and the metro area has some truly excellent cuisine - look for suggestions in your registration packet next April. Sports and entertainment venues include Coors Field (the Rockies may be in town!) and the Pepsi Center.

If Park Meadows Mall isn't enough shopping for you, there are also Cherry Creek Mall in southeast Denver and Flatirons Mall on Route 36 to Boulder. The Tattered Cover Bookstore, a notable feature of Cherry Creek for many years and one of the nation's top independent bookstores, has now moved to the historic Lowenstein Theatre on Colfax Avenue.

Also nearby are numerous interesting destinations including the Butterfly Pavilion (www.butterflies.org) on Highway 36 to Boulder, Boulder itself, Golden (with the Coors Brewery, the Buffalo Bill Museum and Grave on Lookout Mountain, and the Colorado Railroad Museum), the Castle Rock Factory Outlets Stores just south of the Tech Center, and, of course, the mountains. The entrance to Rocky Mountain National Park is only about an hour and a half north of Denver off of I-25. There may still be ski areas open for spring skiing in April; I-70 West is a quick access. The Air Force Academy, Pikes Peak (with its cog railway), Garden of the Gods, Manitou Springs, and Cove of the Winds are just a few of the attractions in the Colorado Springs area, just an hour to an hour and a half south on I-25.

As the "Mile High City", Denver is on the high plains right at the gateway to the spectacular Rocky Mountains. When planning for your trip to the convention, remember that while days may be quite warm, temperatures always cool down in the evening, and weather changes can and do occur frequently.

Please see the RMPA 2010 Convention Information section in this newsletter for hotel reservation details.

See you in Denver!



Denver Tech Center Area Restaurant Guide

Anthony's Pizza \$
66840 South Dallas Way
303-706-1281

Applebee's \$
10440 E. Arapahoe Road
303-792-3126

Bayou Bob's \$\$
9650 E. Arapahoe Road
303-740-7772

Bennigan's \$
9281 E. Arapahoe Road
303-792-0280

Brook's Restaurant \$\$\$
6538 S. Yosemite Circle
303-770-1177

C.B. & Potts \$
6575 Greenwood Plaza Blvd.
303-770-1982

California Pizza Kitchen \$\$
8585 Park Meadows Center Dr.
303-873-0400

Champs Americana Restaurant \$
8315 Park Meadows Center Dr.
303-799-1333

Cheesecake Factory \$\$
8405 Park Meadows Center Dr.
303-858-1111

Del Frisco's Double Eagle Steakhouse \$\$\$
8100 E. Orchard Road
303-796-0100

Earl's \$\$
8335 Park Meadows Center Dr.
303-792-3275

Flemming Steak House \$\$\$
191 Inverness Drive
303-768-0827

Fresh Fish Company \$\$
7800 E. Hampden Ave.
303-740-0556

Grand Slam Sports Bar \$
9660 E. Arapahoe Road
303-799-1300

Gunther Toody's Diner \$
9220 E. Arapahoe Road
303-799-1958

iHOP \$
7017 S. Clinton
303-790-1818

Il Fornaio \$\$
8000 E. Bellevue Ave.
303-221-8400

India's Clay Oven \$\$
9447 Park Meadows Drive
303-768-8188

J. Alexander's \$\$
9709 E. County Line Road
303-708-8432

Landry's Seafood House \$\$
7209 S. Clinton
303-792-0285

Las Brisas \$\$
6787 S. Clinton
303-792-3212

Le Peep Restaurant \$
8081 E. Orchard Rd.
303-796-7337

Macaroni Grill \$\$
7979 E. Arapahoe Road
303-220-7866

Maggiano's Little Italy \$\$
7401 S. Clinton
303-858-1405

Mimi's Café \$\$
9155 Park Meadows Drive
303-799-1211

Morton's of Chicago \$\$\$
8480 Bellview Ave.
303-409-1177

Outback Steakhouse \$\$
10433 E. Costilla Ave.
303-792-2903

P. F. Chang's \$\$
8315 Park Meadows Center Dr.
303-790-7744

Red Robin \$\$
8585 E. Arapahoe Road
303-771-3350

Sahara: Moroccan & Lebanese \$\$
9636 E. Arapahoe Road
303-790-4707

Sonoda's Japanese Restaurant \$\$\$
9623 County Line Road
303-708-8800

Trail Dust Steakhouse \$\$
7101 S. Clinton
303-790-2420

Yia-Yia's Euro Café \$\$\$
8310 E. Bellevue Ave.
303-741-1110

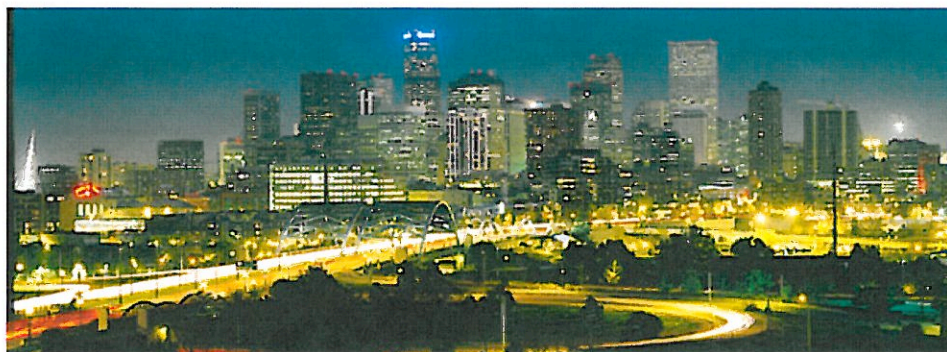

Union Station:
Lower Downtown (LoDo)•
Coors Field•16th Street Mall

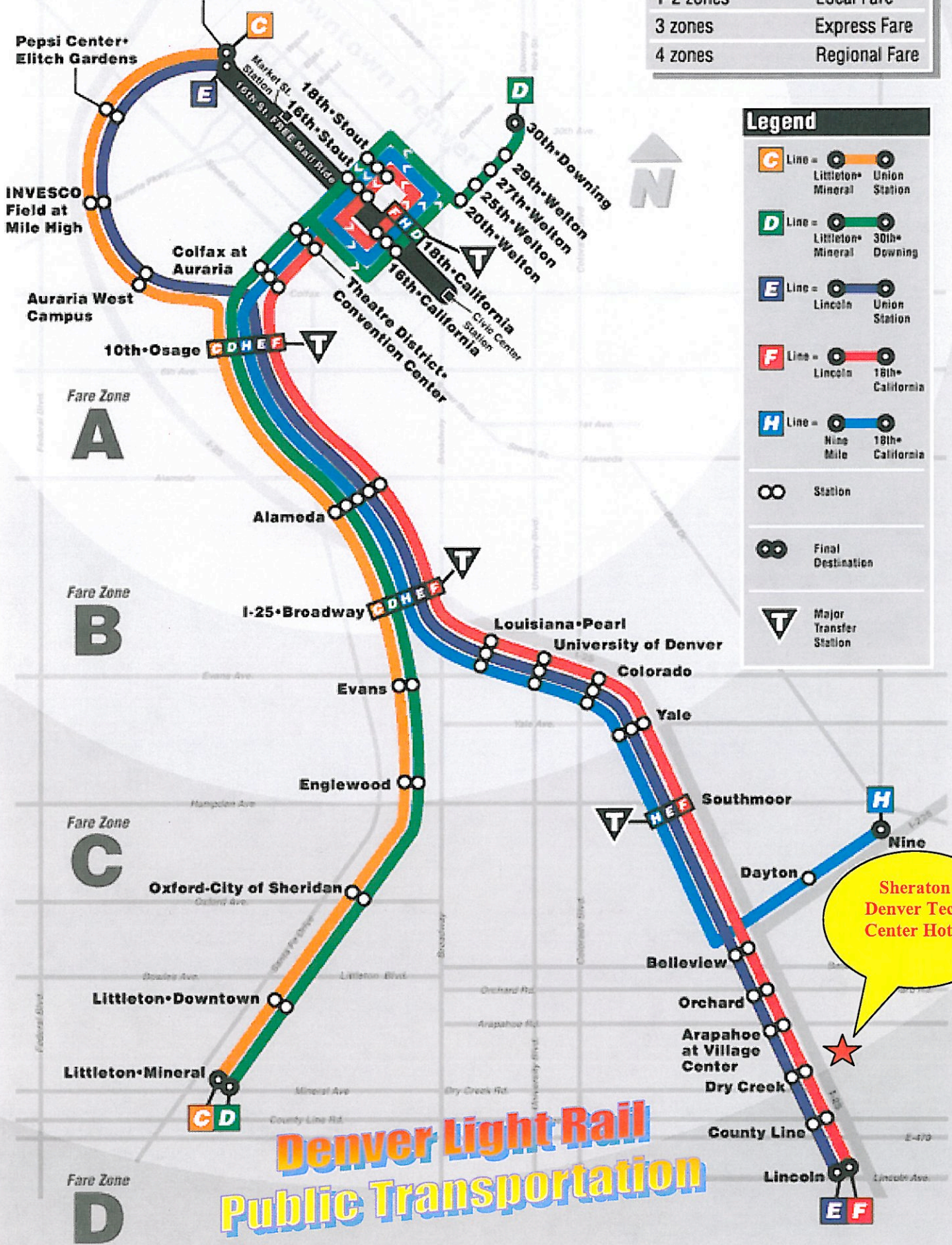

Arizona Colorado Idaho Montana Nevada New Mexico Utah Wyoming

ELECTION RESULTS

Congratulations to **Doug Woody** and **Layton Curl** on their elections. During the next RMPA Business Meeting, Doug Woody will become President-Elect and Layton Curl will become the Diversity Council Chair.



Doug Woody



Layton Curl

RMPA FUTURE CONVENTION SITES

2011

Salt Lake City, Utah
Radisson Hotel – Downtown
April 14-16



2012

Reno, Nevada
Peppermill Resort Spa Casino
April 12-14



2013

Denver, Colorado
Renaissance Denver Hotel
April 11-13



Rocky Mountain Psychological Association
81st Annual Convention of the
Rocky Mountain Psychological Association
April 14-16, 2011
Radisson Hotel Salt Lake City Downtown

RMPA 2011
Salt Lake City

DEADLINES	LOCATION
Submissions	Radisson Hotel - Downtown
Faculty January 8, 2011	215 West South Temple
Reservations January 16, 2011	Salt Lake City, Utah 84101
Advanced Registration	Phone: 801-531-7500
Convention March 13, 2011	Reservations: 1-800-399-7046
Note: March 23, 2011	www.radisson.com/saltlakecity/2011
	http://www.rmpa.org/convention

www.rockymountainpsych.org

RMPA 2011 Posters (11 X 17) for display in your department are available for free by contacting the RMPA Secretary at rycekr@unk.edu or pick up a few at this year's convention.

Thanks to MSCD !



The Rocky Mountain Psychological Association would like to express its sincere appreciation and thanks to the **Metropolitan State College of Denver** for providing Lap-tops, LCD projectors, and other Audio-Visual equipment for this year's convention. Special thanks to Aaron Richmond, Convention Managers, who coordinated that effort.

Special Thanks

The RMPA Executive Committee would like to thank the following organizations for their support of this year's Rocky Mountain Psychological Association Convention.

American Psychological Association for funding the APA Distinguished Lecturer and the APA Education Directorate for funding outstanding student papers at the convention.

Association for Psychological Science for funding the William James APS Lecture.

Society for the Teaching of Psychology for funding the best teaching poster competition.

Psi Chi for funding the student research and the Psi Chi Lecture.

RMPA Convention at a glance:

Psi Chi Distinguished Lecture

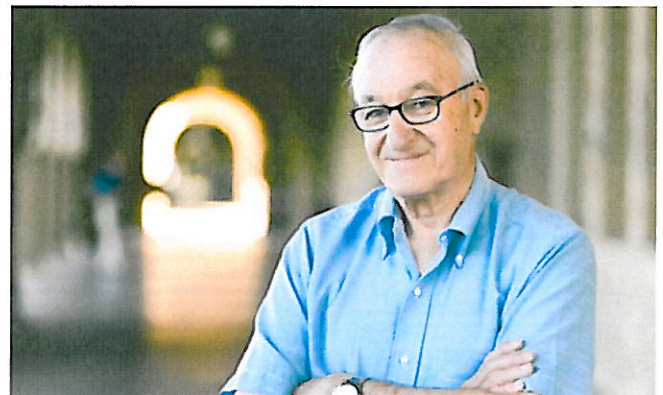

Albert Bandura
Stanford University

APA
Distinguished Lecturer

Jacquelynne Eccles
University of Michigan

Race/Ethnicity as a Context for Adolescent Development

Race/Ethnic group educational disparities continue to exist in the USA. In this talk, Dr. Eccles will discuss the ways in which being a member of a particular ethnic group might influence educational achievement. She will stress the undermining influence of experiences of racial/ethnic discrimination in school on students' school engagement. She will present findings from the Maryland Adolescent Development in Contexts Study (MADICS) showing that a strong African American social identity can buffer the negative effects of racial discrimination on African American youth's school achievement and mental health.



Portenier/Wertheimer Teaching Conference
Keynote Address

Wayne Weiten
University of Nevada Las Vegas

Textbooks in Transition: Controversies and Practical Realities

Textbooks continue to play a central role in most undergraduate psychology courses. The textbook enterprise brings together people from two very different worlds: the world of academia and the world of business. In this talk, I will provide an inside view of how textbooks dual identity influences these crucial teaching materials. Among other things, we will discuss why new editions come out so frequently, why texts are so lengthy, whether there is any validity to the criticism that they are all clones of each other, whether the extensive pedagogical aids in texts really facilitate learning, the importance of readability, the educational value of burgeoning ancillary materials, the reviewing process, and the specter of political correctness. I will also present objective, historical data on the controversy regarding escalating textbook prices and discuss what professors can do to reduce text costs for their students.

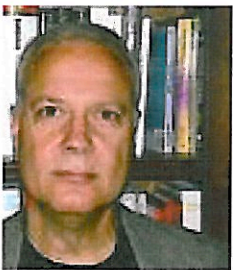

APS
William James Lecturer

Varda Shoham
University of Arizona

The Bumpy Road Toward a Scientifically Principled Clinical Psychology

Despite overwhelming evidence that specific psychosocial treatments work, many practicing psychologists neither use these effective interventions nor value the scientific evidence that validates them. In a recent *Psychological Science in the Public Interest* monograph, my colleagues and I traced the dimensions of this widening gap between scientific progress and clinical practice (Baker, McFall & Shoham, 2009). In this talk I will summarize the monograph's central arguments, elaborate on several points we did not fully develop, and will also respond to some of the criticisms we have heard, both from inside and outside scientific psychology. Finally, I will discuss the promise of a new accreditation system (PCSAS) designed to recognize and brand clinical psychology training programs that are truly science-based.



Presidential Distinguished Lecture

Ludy T. Benjamin, Jr.
Texas A&M University.

Why Are We Keeping Psychological Science a Secret? Psychology's Public Image and Why We Should Care about It

This presentation describes the recent political attacks on the value of psychological science and the accompanying proliferation of bogus therapies masquerading as legitimate psychological treatments, actions that have significantly affected the public's understanding of psychology and psychology's public image. The presentation begins with a historical treatment describing the activities of pioneering American psychologists in educating the public about their new science and its applicability to human problems, and it traces such educational activities to current times. The conclusion speaks to the potential role of psychology in the 21st century and the importance of scientific recognition and the public image of the discipline in enabling psychology to fulfill that role.



Diversity Council Invited Address

Theresa Hernández
University of Colorado at Boulder

Novel Therapeutic Strategies to Improve Outcome following Traumatic Brain Injury

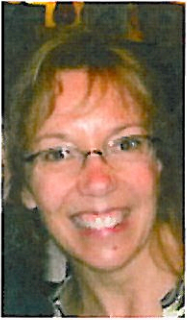

Diversity is created through inclusion and acceptance of individuals with varied backgrounds. One of the primary benefits of a diverse community is the increased likelihood of diversity in thought and inquiry, leading to shifts in the way in which a particular area of study is viewed. Dr. Hernández will describe the ways in which her research over the past 2 decades has created such shifts in the areas of novel therapeutic strategies to improve outcome

after traumatic brain injury and interpretation of the brain's innate response to injury.

RMPA Past-President Address

Richard L. Miller
University of Nebraska at Kearney

In the Beginning -There was Undergraduate Research in Psychology

In this talk, Dr. Miller will discuss the early history of undergraduate research in psychology including a description of some notable labs that involved undergraduate students in research. He will discuss how the curriculum developed to include lab experiences for undergraduates at many colleges and universities and the role undergraduate research played in the development of several noteworthy psychologists. Finally, Dr. Miller will describe the work of several individuals whose record of mentoring undergraduate student research psychology was outstanding.



Worth Publishers Lecture



Sandra Hockenbury
Tulsa Community College

*"Are We Here Yet?
Mindfulness in
Contemporary
Psychology"*

Wertheimer-Portenier Teaching Pre-Conference

The Teaching Pre-Conference will begin at noon on Thursday, April 15. Our keynote address will be given by Wayne Weiten. Wayne teaches psychology and mentors teaching assistants at the University of Nevada, Las Vegas. He is the author of several textbooks and has received distinguished teaching awards from Division 2 of the American Psychological Association (APA) and from the College of DuPage, where he taught until 1991. He is a past-president of the Society for Teaching Psychology. Several symposia on teaching topics have been organized including: Stereotype Threat in the Classroom, Teaching the History of Psychology, Criminal Justice Issues in Psychology, Teaching Non-traditional Students, and Data collection in online teaching: Turning teaching questions into research.. We plan on holding teaching workshops on Storytelling, Balancing Family and Academia, and Best Practices in Engaged Learning. As a part of the pre-conference, there will be *Teaching Take-Out* of short, interactive demonstrations and exercises in several different areas of psychology.

2010 Ellis-Battig Memory Symposium

Optimizing the Training of Knowledge and Skills: A Review of Accomplishments from the Multidisciplinary University Research Initiative (MURI) on Training

Brief Summary: The goal of this MURI has been to construct a theoretical and empirical framework that can account for and make accurate predictions about the effectiveness of different training methods over a wide range of tasks. The work that will be described in the symposium falls into two interrelated categories: First, experiments will be reported that identify and empirically test training principles. Second, predictive computational models will be discussed that embody the training principles.

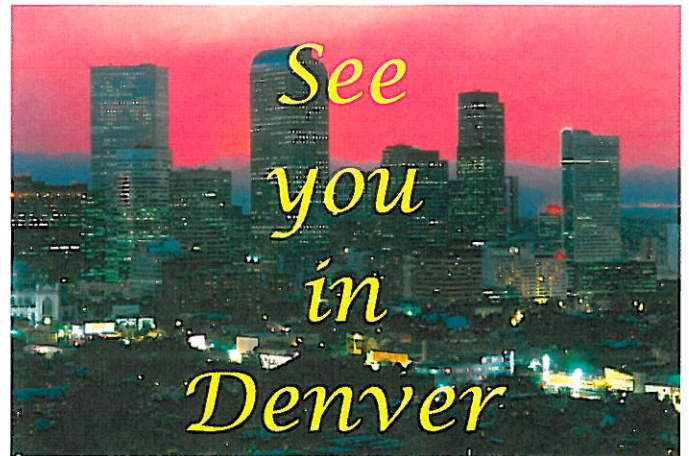

The Rocky Mountain Psychological Association Newsletter is published twice a year, Fall and Spring, and posted on the RMPA website www.rockymountainpsych.org. Please direct any inquiries to the Editor, Robert Rycek, RMPA Secretary, at rycekr@unk.edu

2009-10 RMPA Executive Committee



President
Eric Amsel
Weber State University
eamsel@weber.edu



President-Elect
Pennie Seibert
Boise State University
pennieseibert@boisestate.edu



Past President
William Wozniak
University of Nebraska at Kearney
wozniakw@unk.edu



Secretary
Robert Rycek
University of Nebraska at Kearney
rycekr@unk.edu



Treasurer
Cheryl Sanders
Metropolitan State College of Denver
sandersc@mscd.edu



Historian/Archivist
Richard Miller
University of Nebraska at Kearney
millerr1@unk.edu



Program Chair
Diane Martichuski
University of Colorado, Boulder
diane.martichuski@colorado.edu



Diversity Chair
Susan Becker
Mesa State College
sbecker@mesastate.edu



Convention Coordinator
Nancy Karlin
University of Northern Colorado
nancy.karlin@unco.edu



RMPA 2011
Salt Lake City
April 14-16, 2011

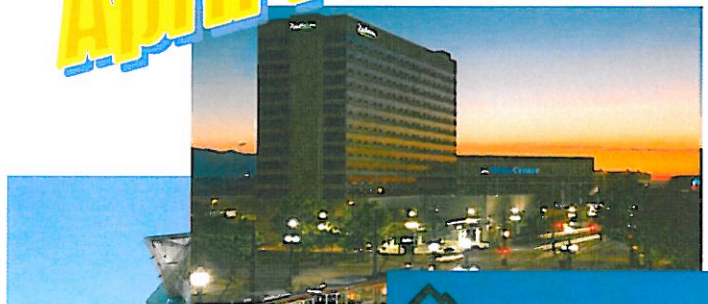

Rocky Mountain Psychological Association
81st Annual Convention of the
Rocky Mountain Psychological Association
April 14-16, 2011
Radisson Hotel Salt Lake City Downtown



RMPA 2011
Salt Lake City

DEADLINE'S	LOCATION
Submissions: Faculty: January 8, 2011 Students: January 15, 2011 Advanced Registration: Completion: March 13, 2011 Hotel: March 23, 2011 www.rmpa.org	Radisson Hotel - Downtown 215 West South Temple Salt Lake City, Utah 84101 Phone: 313-53-7200 Reservations: 1-800-335-7016 www.radisson.com www.radisson.com

www.rockymountainpsych.org

